

# Poles Relocated

## Section View Showing Poles Relocated

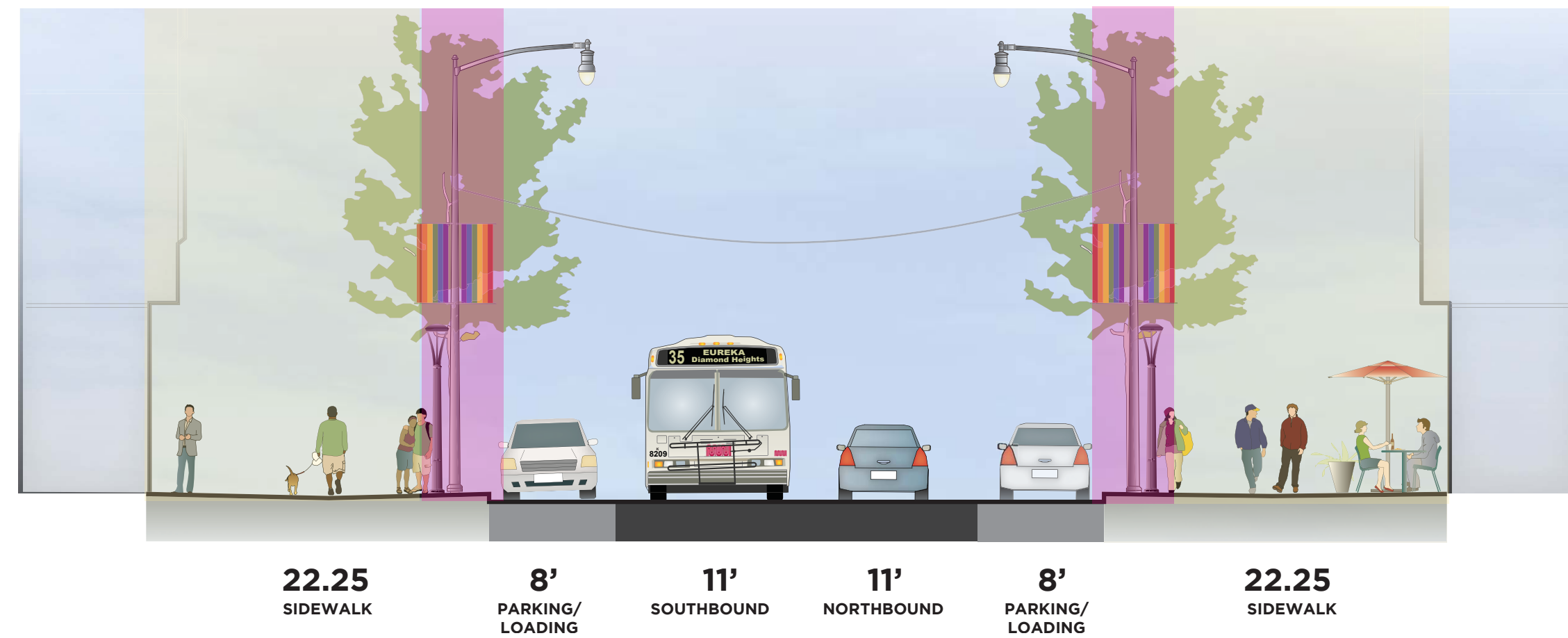

The schematic design for Castro Street includes relocating muni/light poles to the widened sidewalk curb. A single row of trees would be planted in-line with the new poles. Having only one line of vertical elements allows for more flexible use of the sidewalks. These drawings illustrate the schematic design for the street with the poles relocated.

## Plan View Showing Poles Relocated

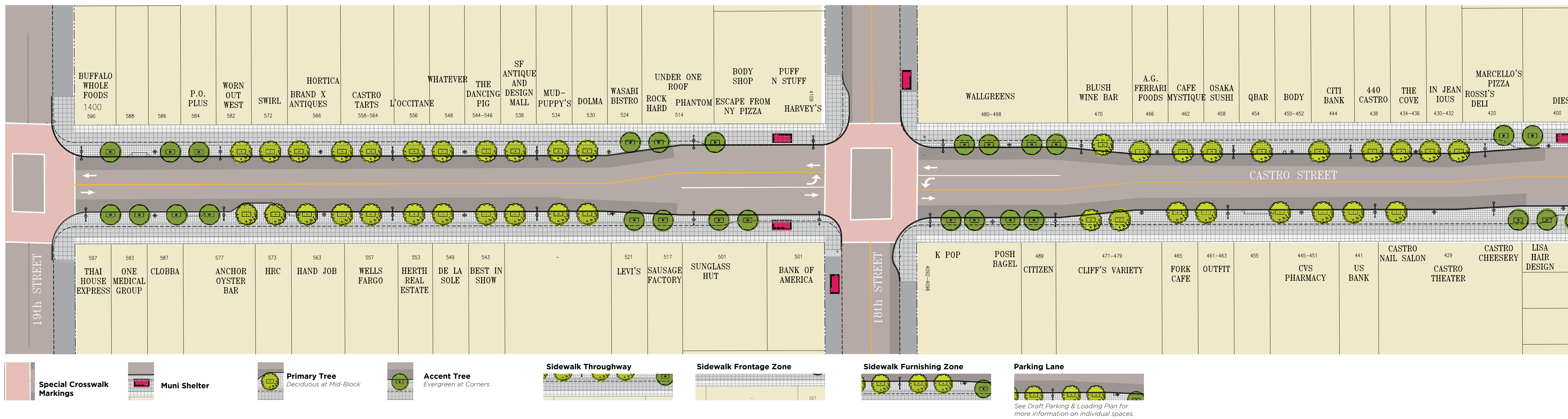

## Poles In Place

### Section View Showing Poles in Place

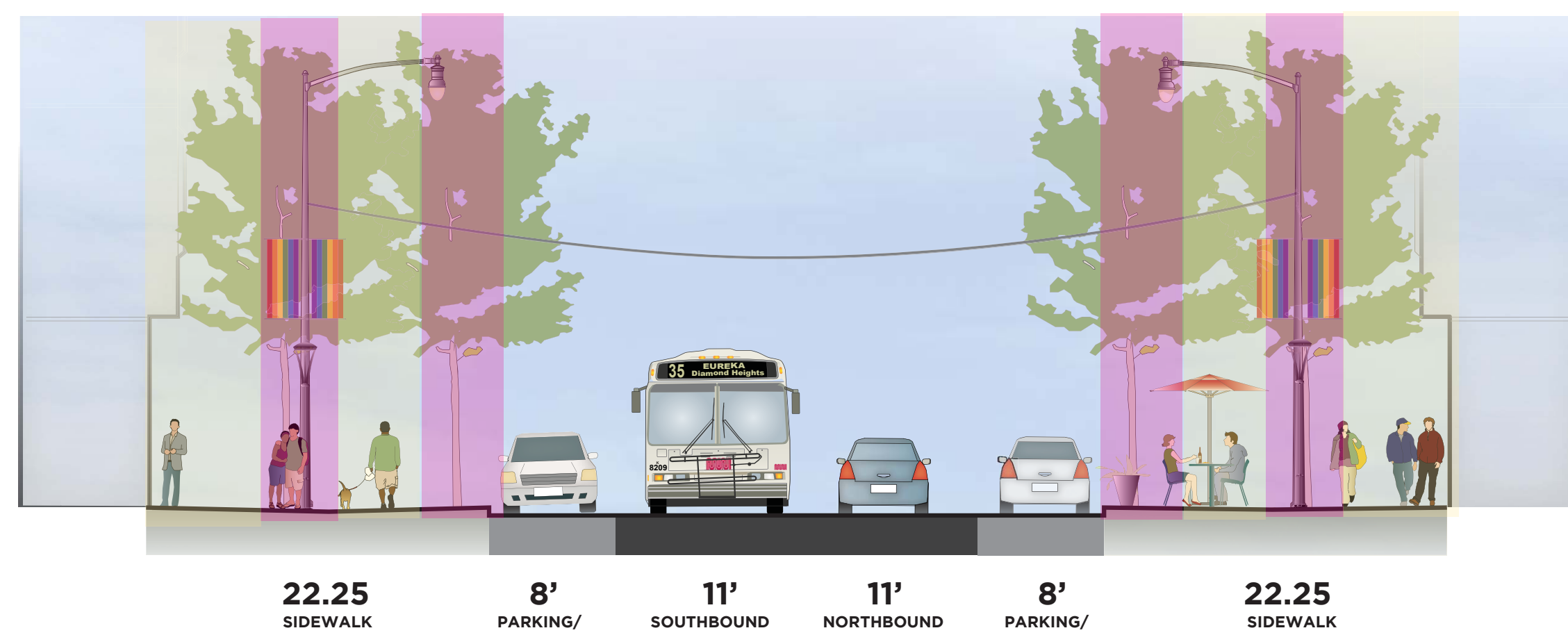

Depending on budget, timing, and community preference - Castro Street's Muni/light poles could remain in-place. A second row of trees in-line with the poles could be added in this option. These drawings illustrate a schematic design for the street with the poles in place.

## Plan View Showing Poles in Place

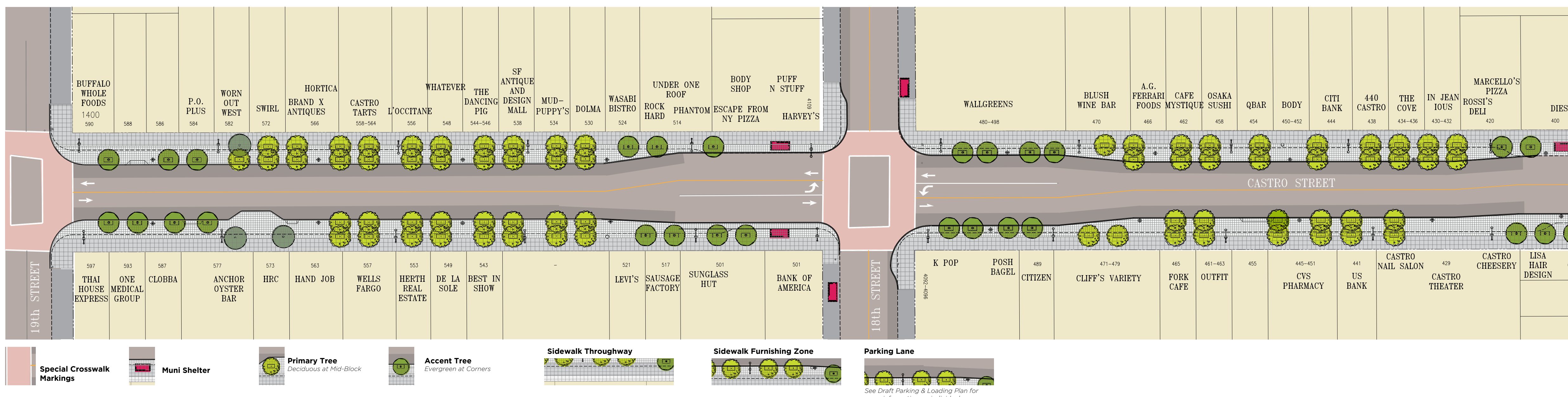

## Schematic Sidewalk Layout - Poles Relocated



## Local Precedent Photos of Sidewalk Layout



Center Street, Berkeley - Linking BART to UC Berkeley  
Photo by Sharon Hahn Darlin

## Schematic Sidewalk Layout - Poles in Place

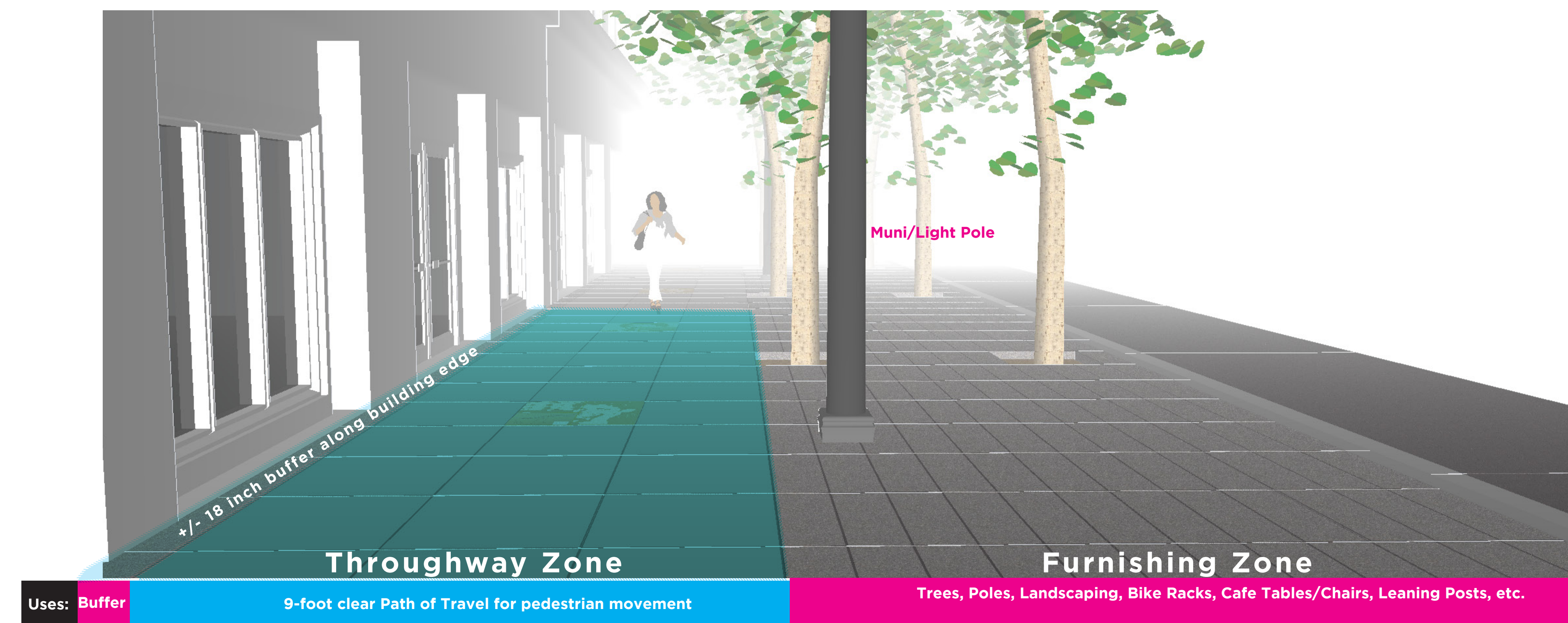

## Local Precedent Photos of Sidewalk Layout



Valencia Street, San Francisco

Market Street at New Montgomery, San Francisco