



IMPROVE YOUR PATH TO THE PARK

**Connecting
pedestrians, bicyclists,
and wildlife to the
City's green spaces.**

<http://greenconnections.sfplanning.org>

Project Overview

- Two-year planning process
 - Year 1: Citywide Focus
 - Year 2: Neighborhood Focus
- Project Goal: Improve Connections to Open Space
 - Public Health
 - Air Quality
 - Sustainability
 - Create Habitat
 - Economic Justice

Project Team

City Agencies

SAN FRANCISCO
PLANNING DEPARTMENT

SFMTA | Municipal Transportation Agency



SFDPH
Environmental
improving environments
protecting health



Community Partners



Building on Existing Plans and Policies

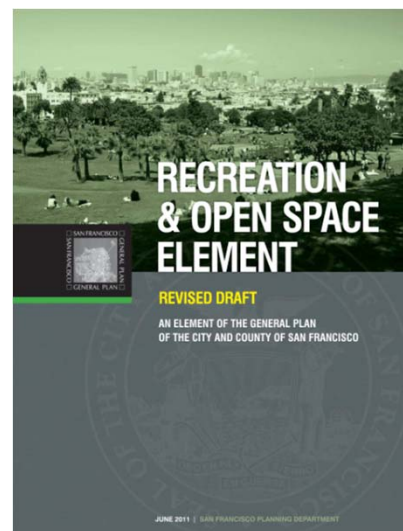
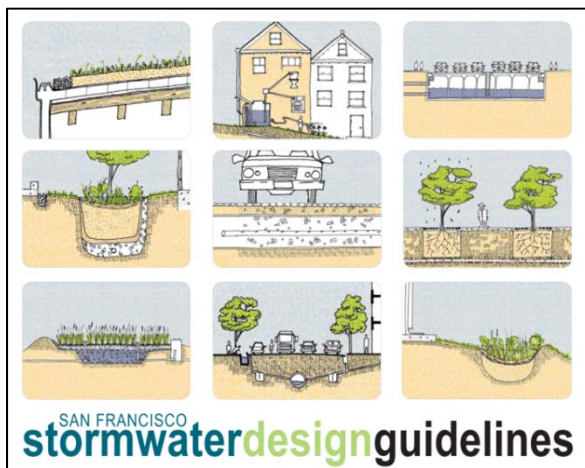

What is a Green Connection?

A Green Connection is a special street or path that connects people to parks and open spaces and enhances the ecology of the street environment.



What is a Green Connection?



What is a Green Connection?

- Encourage and Support Active Transportation
- Enhance Urban Ecology
- Promote Stewardship and Placemaking



Encourage and Support Active Transportation



Hudson River, NYC



Enhance Urban Ecology

Shotwell Street



Promote Stewardship & Placemaking

Quesada Gardens,
Bayview



Chronicle / Liz Hafalia

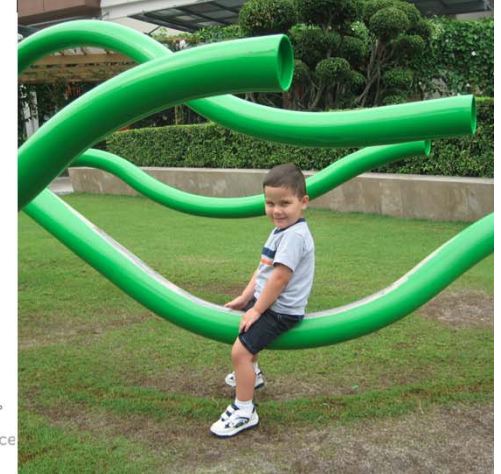

Key Project Deliverables

- A Citywide Green Connections network – *draft available*
- Design Toolkit Concepts – *draft available*
- Streetscape Designs - Focus Neighborhoods - *ongoing*
- Implementation Plan – *ongoing*

Developing the DRAFT Network

Goal: Improve Connections to Open Space

- Existing plans
- Community input
- Community plans
- Agency input



Developing the DRAFT Network

- Build on Opportunities
 - streets with low traffic volumes
 - low speeds
 - near schools
 - streets with space to gather and play
 - bike network

- Avoid Conflicts
 - streets with fast moving traffic
 - key muni routes
 - truck routes



DRAFT Green Connections Network

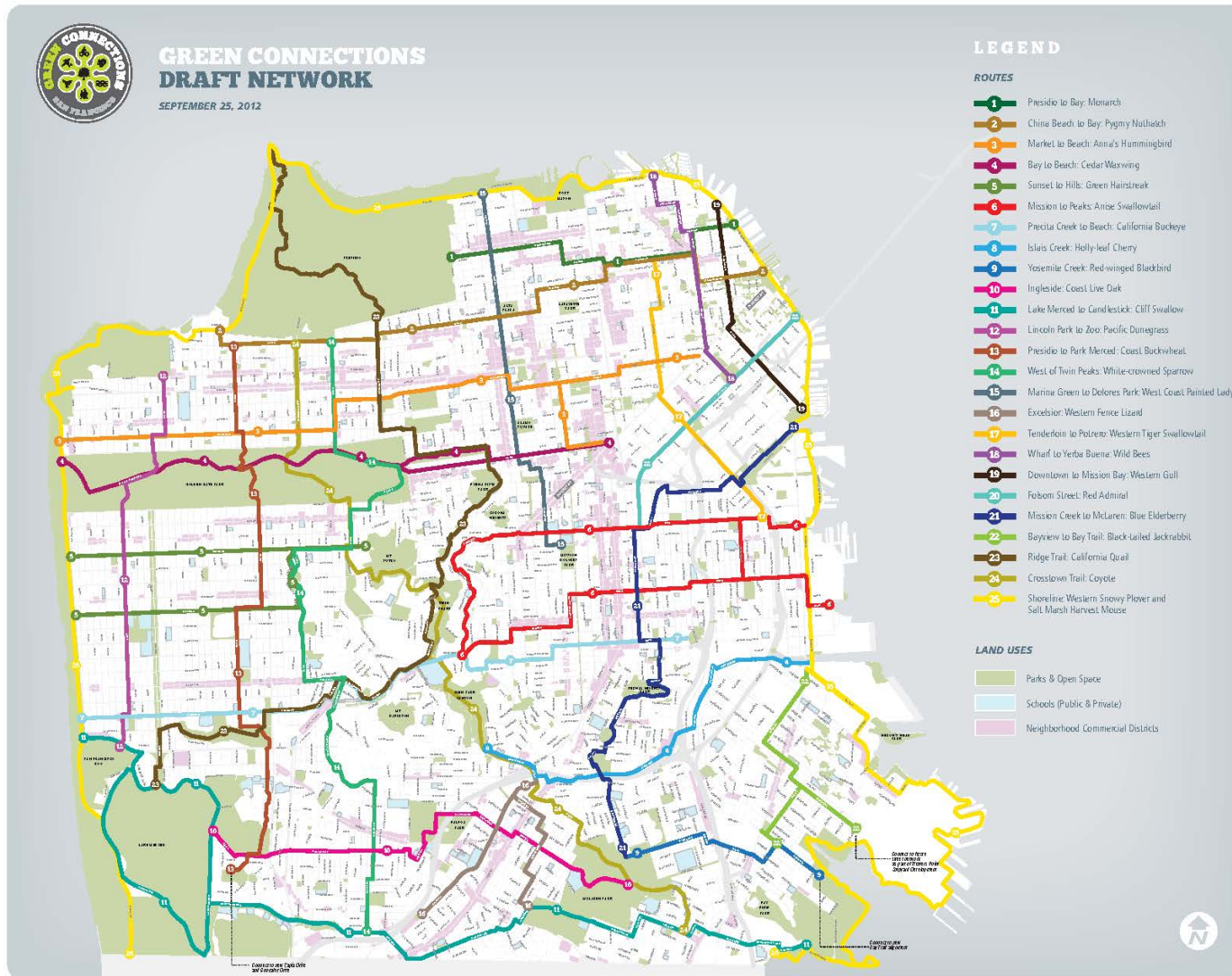

- 25 Routes, 140+ miles
- Route name: geographic start & end point and a target species
- Special set of routes that people will go out of their way to use

Testing the DRAFT Network – *in process*

- Community Feedback
- Improve access to parks and open spaces
 - Equal access to the network - every household is within a 1/2 mile of a Green Connection
 - Focus in areas with high need – youth, seniors, lower household income and limited access to private vehicles.
- Implement the network over a twenty-year time period
 - Coordinate with city projects

DRAFT Design Toolkit

Range of interventions:

- Intersection Treatments
- Block Treatments

Designs intended to support:

- active transportation
- urban ecology
- stewardship & placemaking

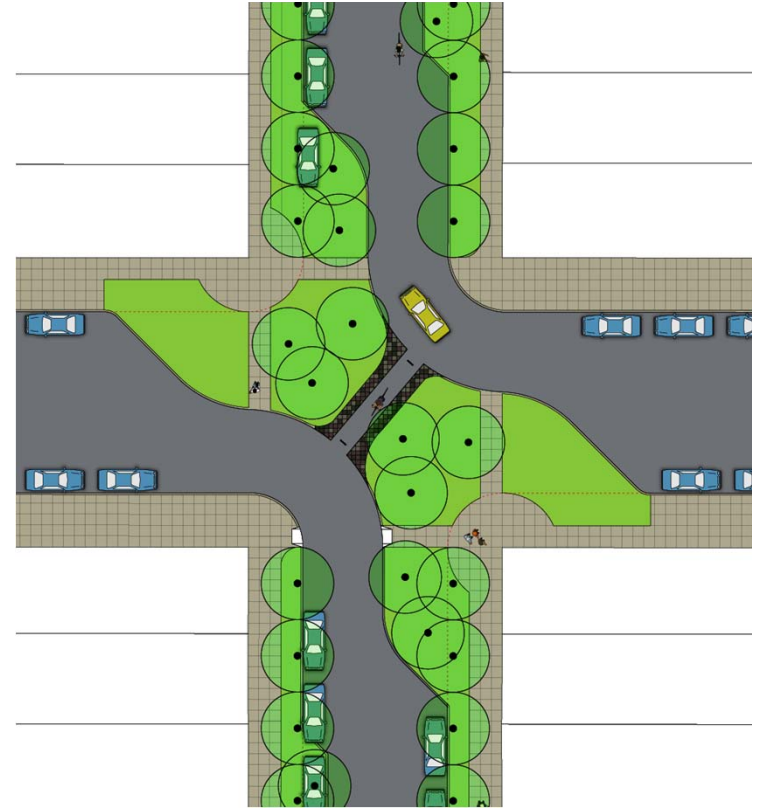

DRAFT Design Toolkit

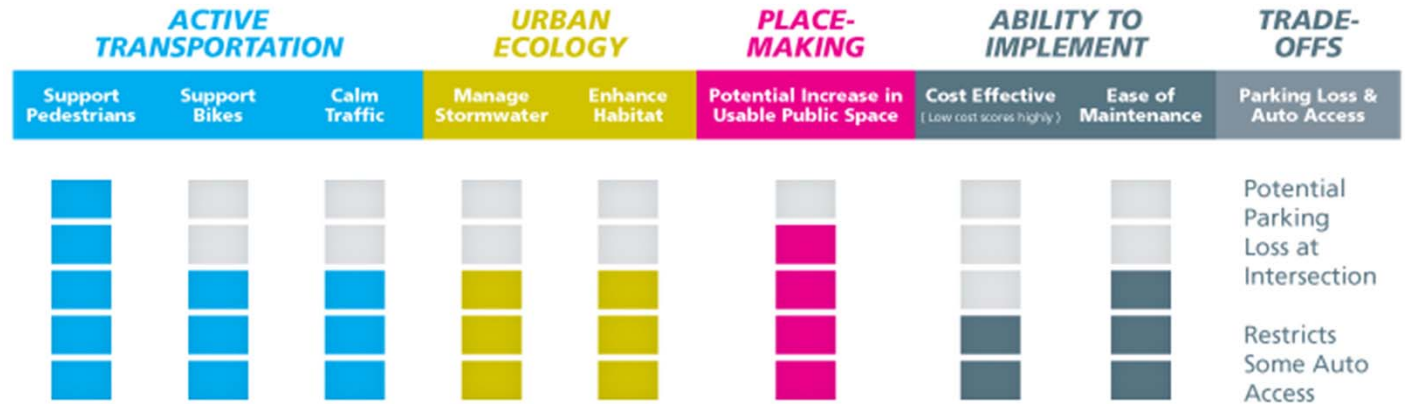
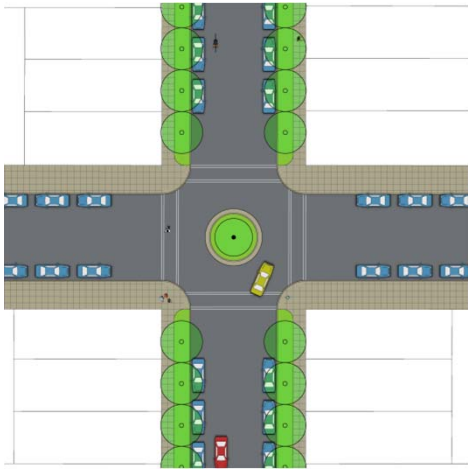

Green Connections: Intersection Treatments

INTERSECTION ISLAND

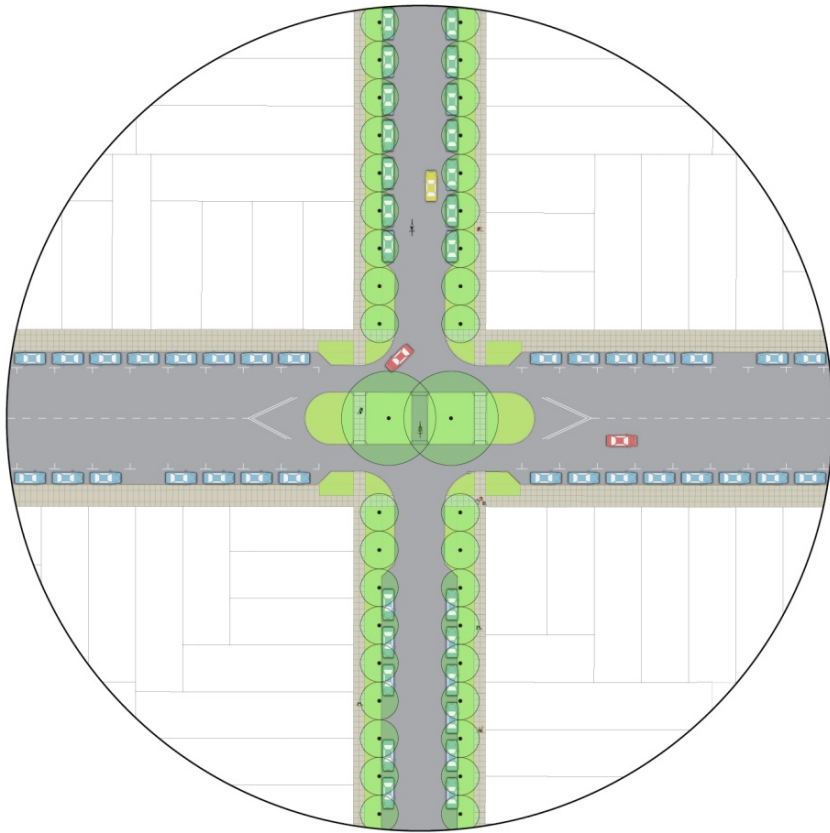

DIVERTER

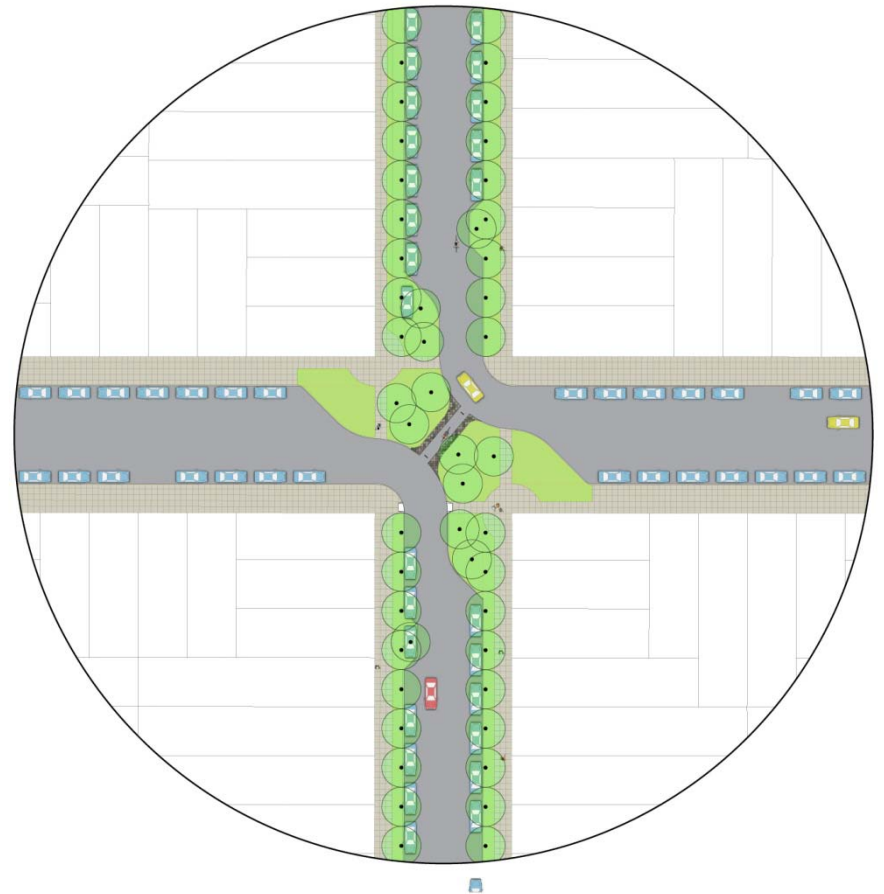

Intersections



Blocks: Chicane

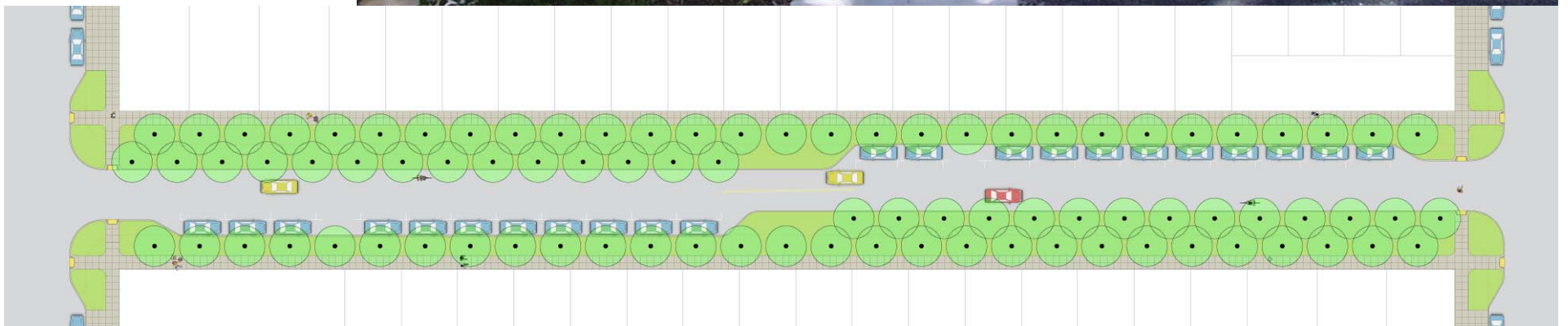

Blocks: Neckdown

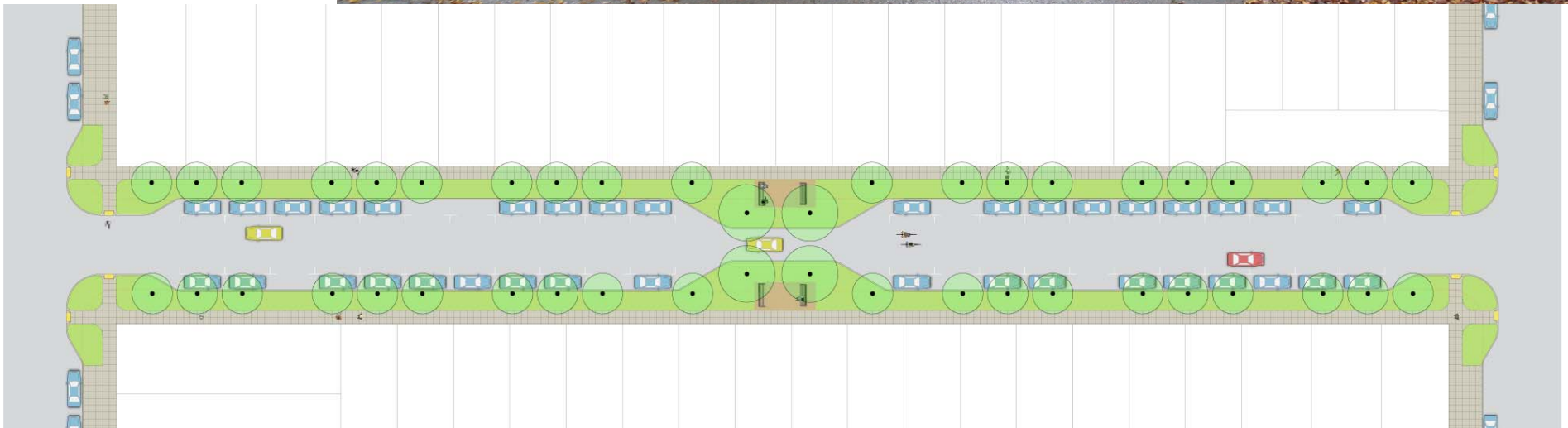

Next Steps

- **Citywide Green Connections**
 - Winter 2013: Collect public feedback on DRAFT network and design toolkit
 - Spring 2013: Revise draft documents
 - Fall 2013: Final documents
- **Concept Designs in focus neighborhoods**
 - Winter: Community Planning process
 - Spring: Draft design completed

Stay Involved!

- **Provide input on Citywide Network & Design Concepts**
 - Project website
<http://greenconnections.sfplanning.org>
 - Facebook Page
<http://www.facebook.com/greenconnections.sf>
 - Online survey - **Ends March 7th**
 - Improve SF Survey

- **Participate in developing a concept design in the focus neighborhood**
 - Join our mailing list! <http://signup.sfplanning.org>
(check the box for “Green Connections”)