

GREEN CONNECTIONS EDDY STREET

“Green Connections” is a two-year community based planning process led by the San Francisco Planning Department. The Project will result in a Citywide network of green streets that can be built over time—improving access to parks, open space and the waterfront. The project builds on current efforts to create sustainable corridors that enhance pedestrian and bicycle conditions, reduce stormwater runoff, improve wildlife habitat and green neighborhood streets. In the Western Addition Eddy was identified as a good candidate for a Green Connection. We are interested to hear your ideas on ways to green the street and make it safer to walk and bike along.

Thank you for joining us on this walk today. Please take a few minutes to complete this feedback form. Your feedback will help the City determine how to prioritize improvements along Eddy Street. Thanks!

Name (optional): _____

Home Address or Intersection (optional): _____ Zip Code: _____

1. What is your favorite part of this walk, tell us why?

2. Did you notice any barriers or conditions that make it difficult or unpleasant to walk along the way? If so, tell us what and where. What would you change to make it better?

3. Where did traffic feel dangerous to you, and why? Where did you feel safe from traffic, and why?

4. What types of improvement would you most like to see on Eddy Street? Check ☒ one.

<input type="checkbox"/> Pedestrian Improvements	<input type="checkbox"/> Bike Improvements	<input type="checkbox"/> Greening & Landscaping	<input type="checkbox"/> Other
Corner bulb-outs	Bike Parking	Sidewalk landscaping	_____
Crosswalks & intersection striping	Bike Facilities	Street trees	_____
Pedestrian scale street lights		Permeable paving	_____
		Rain gardens	_____



RETURN COMPLETED FEEDBACK FORM VIA: EMAIL: LISA.CHEN@SFGOV.ORG FAX: (415) 558-6409
MAIL: San Francisco Planning Department, Attention: Lisa Chen, 1650 Mission Street, Suite 400, San Francisco, CA 94103

5. What intersection would you most like to see improved? Check ☒ one.

- | | | |
|--|--|---|
| <input type="checkbox"/> Eddy Street and Buchanan Street | <input type="checkbox"/> Eddy Street and Laguna Street | <input type="checkbox"/> Eddy Street and Gough Street |
| <input type="checkbox"/> Eddy Street and Franklin Street | <input type="checkbox"/> Eddy Street and Van Ness | <input type="checkbox"/> Eddy Street and Polk Street |

6. What type of greening would you like to see along Eddy?

- | | | |
|---------------------------------------|---|---|
| <input type="checkbox"/> Street Trees | <input type="checkbox"/> Sidewalk Landscaping | <input type="checkbox"/> Corner gardens |
|---------------------------------------|---|---|



7. “Play Streets” can create large areas for people to gather and play. Traffic entering the play street can be calmed with the addition of bulb-outs (corner sidewalk extensions) or speed tables (like wide speed bumps) at the intersection. Play streets are appropriate on residential streets with very low traffic volumes or dead-end streets. Buchanan Street between the Buchanan Mall and Eddy Streets meets this criteria, and is where residents held a Play Streets event on July 13. What do you think about designing this block to allow more play streets?

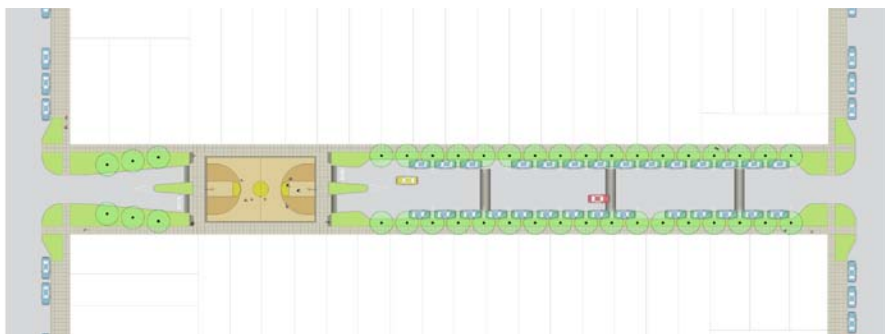

6. Please use the space below to provide any additional comments:

THANK YOU for your input and feedback!

RETURN COMPLETED FEEDBACK FORM VIA: EMAIL: LISA.CHEN@SFGOV.ORG FAX: (415) 558-6409
MAIL: San Francisco Planning Department, Attention: Lisa Chen, 1650 Mission Street, Suite 400, San Francisco, CA 94103