



22ND STREET GREEN CONNECTIONS

San Francisco
Planning



STREETSCAPE GREENING



PEDESTRIAN LIGHTING



BICYCLE SHARROWS



Sidewalk Planters



22ND STREET GREEN CONNECTIONS

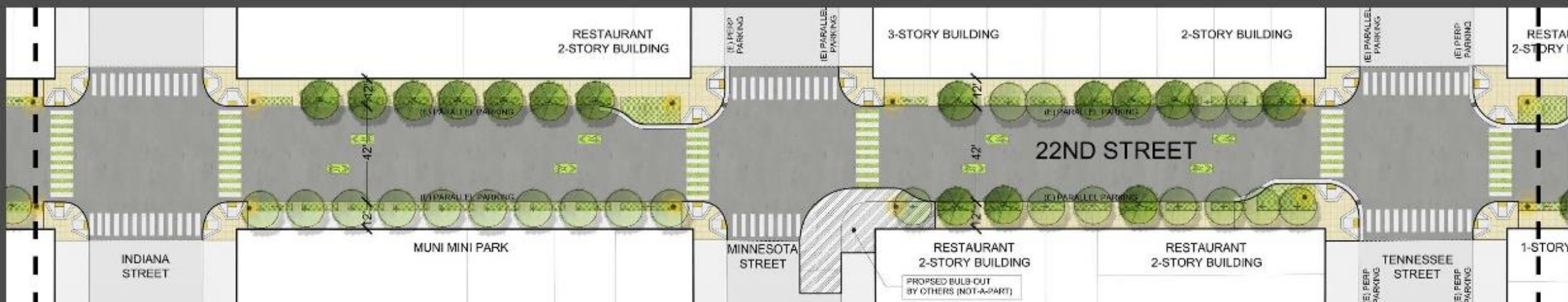

22ND STREET GREEN CONNECTIONS



**22ND STREET
GREEN CONNECTIONS**

Schedule:

The design phase of the 22nd Street Green Connection Streetscape project is kicking off now with Public Works leading the design team. 22nd Street construction (paving and streetscape) will follow the 22nd St Caltrain bridge replacement project (currently scheduled from 1/2016 through 10/2016).

Funding:

\$2 million in development impact fees are currently allocated to the project based on a high level initial estimate of cost.

In 2015 Public Works developed a more thorough cost estimate of what it would take to design and build the project of \$3.5 million.

We are asking that the Eastern Neighborhoods Community Advisory Committee recommend an additional \$1.5 million to fully fund the 22nd Street Green Connection Streetscape project.

For more information, please contact:

Kelli Rudnick (415)-558-4489 / kelli.rudnick@sfdpw.org

**22ND STREET
GREEN CONNECTIONS**

San Francisco
Planning

