

CONCEPTUAL COST ESTIMATE & DESIGN

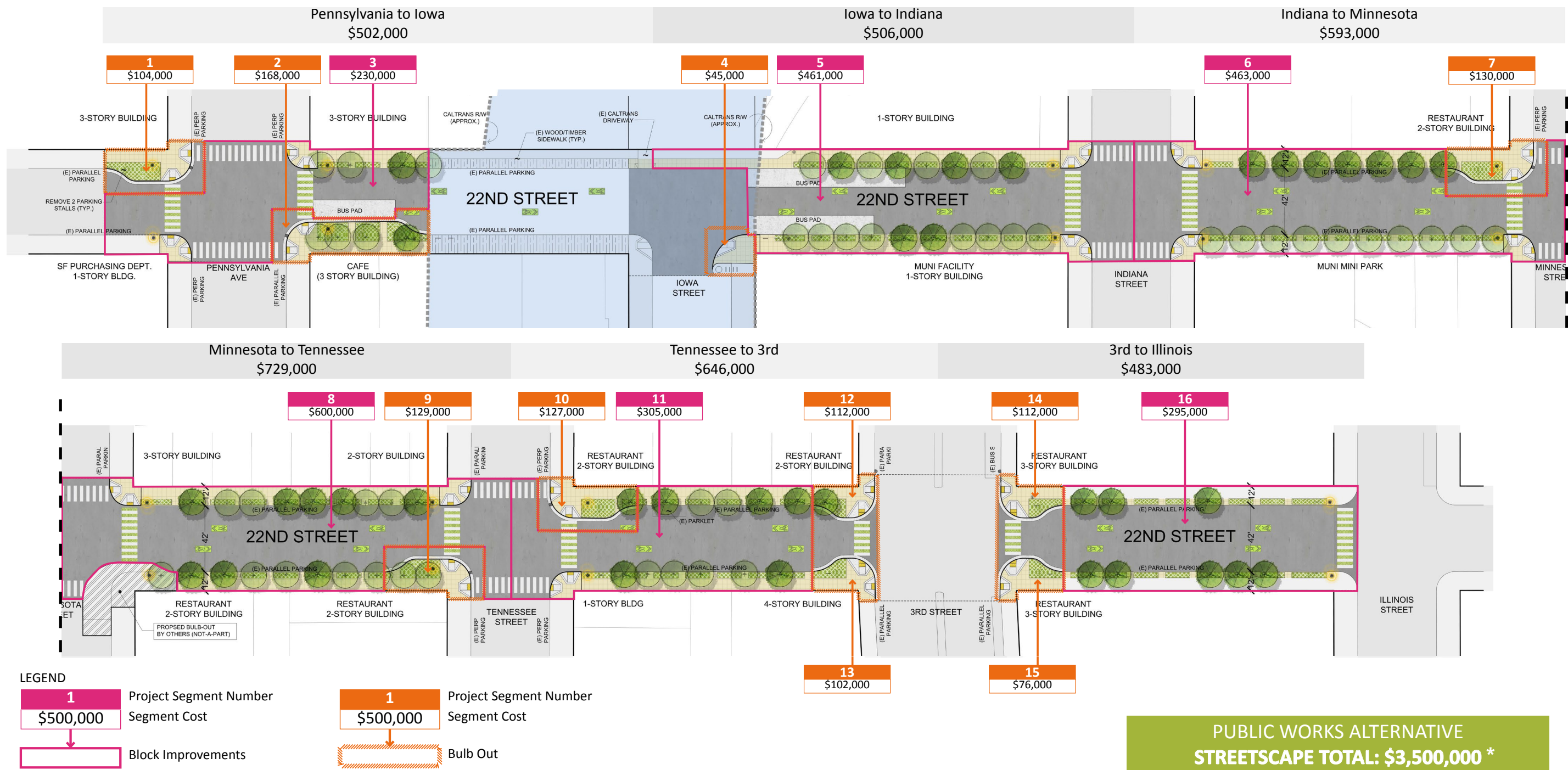

*Funding for paving (~\$500,000) from Illinois Street to Pennsylvania Ave (except for the Caltrain bridge) will come from the Public Works Paving Program budget.

PROJECT SUMMARY: The 22nd Street Green Connection Streetscape project area is from Illinois Street to Pennsylvania Avenue. The project proposes to enhance the public realm of the 22nd Street commercial corridor through tree and understory planting, new pedestrian lighting, replacement of sidewalk concrete where needed and installation of turf block treatments, corner sidewalk bulbouts, new painted crosswalks and bike route markings (sharrows). In addition to the pedestrian and public realm improvements, the project will strengthen the connection

for people cycling from the Illinois St bikeway to the 22nd St Caltrain station at Iowa Street. The 22nd Street Green Connection Streetscape project will coordinate with Public Works paving program's repaving of 22nd Street.

For more information, please contact:
Kelli Rudnick (415)–558–4489 / kelli.rudnick@sfdpw.org
or visit: sf-planning.org/CentralWaterfrontPRP

FEATURES

- 6 Blocks of Repaving (~\$500,000 from Paving Program)
- 19,400 SF New Sidewalks w/ Integral Color
- 9 Bulb-outs
- 42 New Street Trees
- 3 Year Maintenance for New Trees
- 7,150 SF Permeable Paving
- 7,150 SF Low-maintenance, Drought Tolerant Planting
- 7,150 SF Irrigation
- 1,855 SF Special Treatment at Crosswalks @ 6 Intersections
- 18 New Pedestrian Light Fixtures (& Conduit) @ Intersections
- 24 Painted Sharrows
- 21 Bike Posts
- 4 Trash Receptacles (at Bus Stops)

STREETSCAPE GREENING & MATERIALS PALETTE



TURF BLOCK/ "GREEN FUZZ"



BICYCLE SHARROWS



SIDEWALK PLANTERS



PLANTED BULB-OUTS

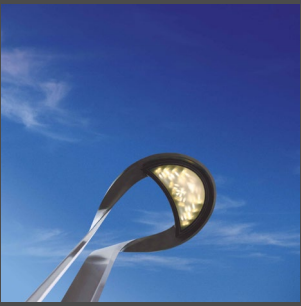
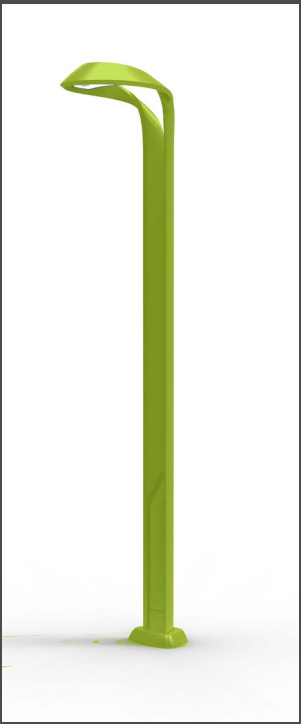

PEDESTRIAN LIGHTING

CONCEPTUAL COST ESTIMATE SUMMARY

SEGMENT	HARD COST	SOFT COSTS	
1	\$104,000	Construction Support	5%
2	\$168,000	Construction Management	10%
3	\$230,000	Design (SF Public Works	
4	\$45,000	Disciplines)	12%
5	\$461,000	Project Management	3%
6	\$463,000	Survey	\$50,000
7	\$130,000		
8	\$600,000	TOTAL=	\$3,500,000*
9	\$129,000		
10	\$127,000	*Funding for paving (~\$500,000) from Illinois Street to Pennsylvania Ave (except for the Caltrain bridge) will come from the Public Works Paving Program budget.	
11	\$305,000		
12	\$112,000		
13	\$102,000		
14	\$112,000		
15	\$76,000		
16	\$295,000		

SCHEDULE

- DOGPATCH & POTRERO COMMUNITY OUTREACH
Summer through Fall 2015
- EASTERN NEIGHBORHOODS COMMUNITY ADVISORY COMMITTEE MEETINGS
September 21
October 19 final presentation and additional funding request
- 22ND ST COMMUNITY WORKSHOP
November/December 2015
- 22ND ST CALTRAIN BRIDGE CONSTRUCTION
January 2016 through October 2016



SPECIAL PAVING AT CROSSWALKS



BIKE RACKS